

规格 Specifications

额定电压 Rated Voltage	12V		
标称容量 Nominal Capacity (C ₂₀ , 1.80V/cell)	150Ah		
尺寸 Dimension	长 Length	532±2mm	
	宽 Width	210±2mm	
	高 Container Height	217±2mm	
	总高(含端子) Total Height	217±2mm	
重量 Approx Weight	54.0kg		
端子 Terminal	M8		
外壳材料 Container Material	ABS		
额定容量 Rated Capacity (25°C)	150Ah	C20(7.50A, 1.80V/cell)	
	143Ah	C10(14.3A, 1.80V/cell)	
	115Ah	C5(23A, 1.75V/cell)	
	73Ah	C1(73A, 1.75V/cell)	
5S最大放电电流 Max. Discharge Current	900A (5s)		
内阻 Internal Resistance(25°C)	Approx 6.0mΩ		
运行温度 Operating Temp. Range	放电 Discharge	-15 ~ 50°C	
	充电 Charge	-15 ~ 50°C	
	存储 Storage	-20 ~ 40°C	
推荐温度 Nominal Operating Temp. Range	25±5°C (77±5°F)		
最大充电电流 Max. Charging Current(25°C)	30A		
充电电压 Charge voltage(25°C)	浮充 Float	2.23~2.27V/cell	温度补偿 Temp. Coefficient -3mV/单格/°C
	均充 Equalization	2.30~2.40V/cell	-4mV/单格/°C
	循环 Cycle	2.35~2.45V/cell	-5mV/单格/°C
	40°C (104°F)		102%
温度对容量影响 Effect of temp. to Capacity	25°C (77°F)		100%
	0°C (32°F)		85%
自放电 Self Discharge	≤3%/月 @ 25°C		

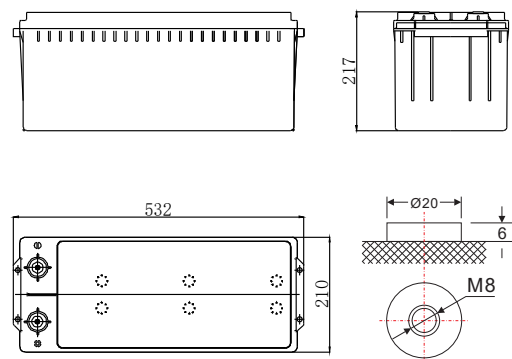

外形 Layout



特征 General Features

- 电池设计浮充寿命12年 (25°C) 12 years design life
- 正极板采用管式极板 adopt tubular plate
- 气相SiO₂胶体电池技术 Gas phase SiO₂ with GEL battery technology
- PVC-SiO₂/PE隔板 PVC-SiO₂/PE Separator
- ABS槽盖材料 ABS material battery case
- 广泛应用于通信系统、军事领域、电力系统、广播电视系统等
Widely used in communication systems, military fields, power systems, broadcasting and television systems, etc

恒流放电表(A) 25°C Constant Current Discharge

F.V/Time	30MIN	60MIN	2HR	3HR	4HR	5HR	6HR	7HR	8HR	10HR	20HR
1.80V/cell	135	71.5	46.0	33.0	26.4	22.6	19.5	19.0	15.2	14.3	7.50
1.75V/cell	143	73.0	47.2	33.5	27.0	23.0	19.9	19.6	15.6	14.4	7.52
1.70V/cell	145	73.6	48.2	33.9	27.5	23.2	20.2	20.1	15.9	14.4	7.55
1.65V/cell	147	73.8	48.8	34.1	27.6	23.3	20.3	20.2	16.0	14.5	7.64

恒功率放电表(W/cell) 25°C Constant Power Discharge

F.V/Time	30MIN	60MIN	2HR	3HR	4HR	5HR	6HR	7HR	8HR	10HR	20HR
1.80V/cell	255	134	87.2	62.6	50.6	43.4	37.5	36.4	29.2	27.4	14.57
1.75V/cell	265	137	88.1	63.1	51.4	43.9	37.9	37.5	29.7	27.4	14.70
1.70V/cell	268	138	89.5	63.6	52.0	44.2	38.2	38.0	30.0	27.4	14.81
1.65V/cell	272	139	90.6	63.9	52.2	44.3	38.5	38.3	30.1	27.5	14.99

放电特性曲线 Discharge Characteristics Curve

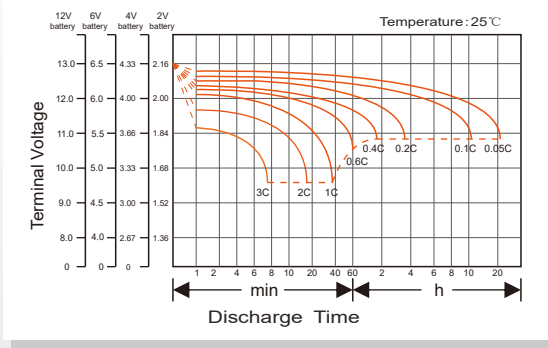

充电特性曲线 Charging Characteristics Curve

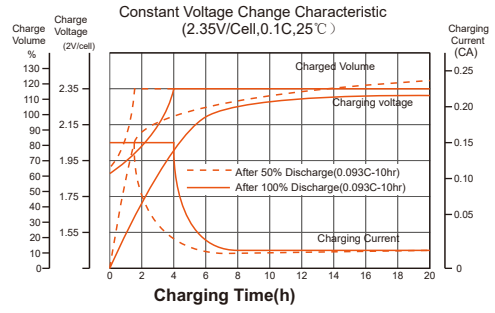

不同放电深度循环寿命 Cycle life of Different DOD

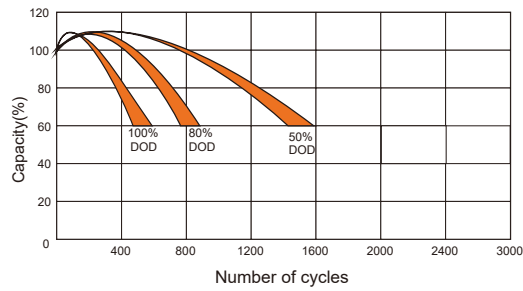

浮充使用寿命 Float charging service life Curve

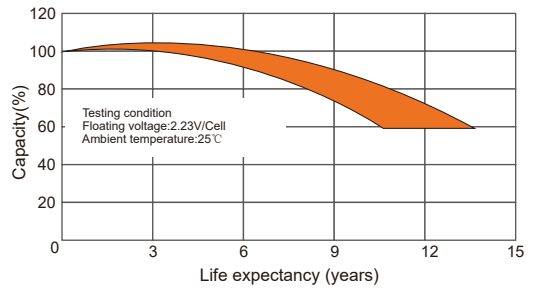

充电电压与温度关系 Charging voltage and temperature relationship

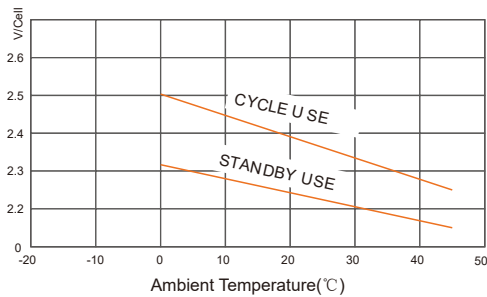

自放电曲线 Self-discharge Characteristics

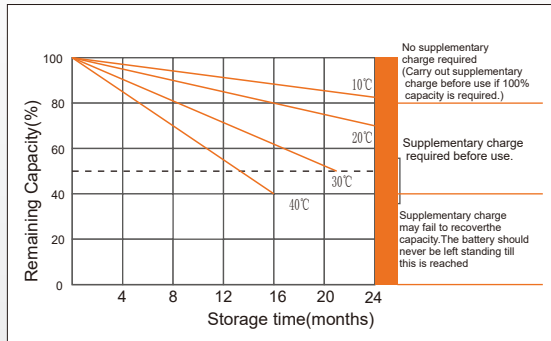

温度对容量影响 Temperature Effects in Relation to Battery Capacity

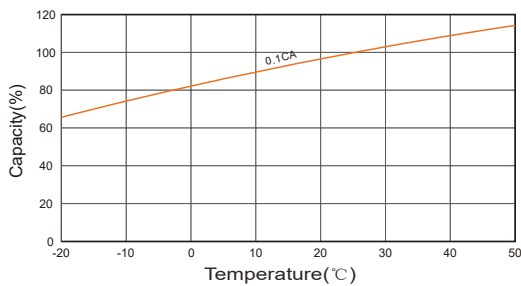

温度对浮充寿命影响 Temperature Effects on Long Term Float Life

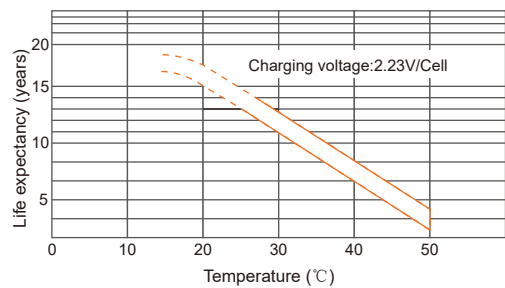

泉州市凯鹰电源电器有限公司

地址：福建省泉州市安溪县滂港村凯鹰工业园
 ADD: Laogang Industry Area, Anxi Town, Quanzhou City, Fujian Province.

电话 Tel: 0595-68782266
 传真 Fax: 0595-68782222
 邮箱 E-mail: sales@longwaybattery.com
 网址 URL: www.longwaybattery.com